

PANERAI

Istruzioni/Instructions

PANERAI

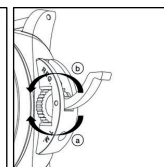
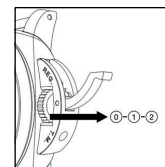
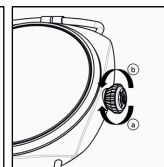
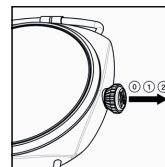
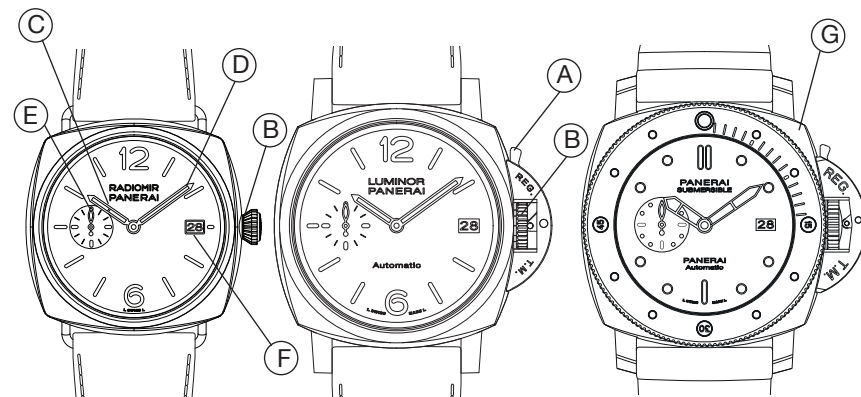

Models without date

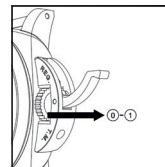

(A) LEVER (B) WINDING CROWN (C) HOURS
(D) MINUTES (E) SMALL SECONDS (F) DATE*
(G) UNIDIRECTIONAL ROTATING BEZEL*

*FOR SOME MODELS ONLY
PICTURES SHOWN ARE FOR ILLUSTRATION PURPOSE ONLY. ACTUAL PRODUCT MAY VARY.

INSTRUCTIONS FOR USE

WINDING THE WATCH

1. Raise the lever **(A)** of the crown cap to release the winding crown **(B)**. For Radiomir models unscrew the winding crown **(B)**.
2. Without pulling it out **(position 0)**, wind it clockwise **(a)** about ten times for partial winding.
3. Lock the winding crown by closing the lever **(A)** (for Radiomir models, screw it again) to ensure waterproofness.

Note: The watch has an automatic mechanical movement with a 3-day power reserve. If the watch has stopped running, it is recommended to partially wind it manually before wearing and using it again. When the watch is fully wound, winding the crown has no effect on the mechanism. Turning the crown **(B)** counterclockwise **(b)** has no effect.

SETTING THE TIME

1. Raise the lever **(A)** of the crown cap to release the winding crown **(B)**. For Radiomir models, unscrew the winding crown **(B)**.
2. Pull it out to the second click **(position 2)** and set the time. For models without the date, pull it out to the first click **(position 2)** and set the time.
3. Return the winding crown **(B)** to the initial position **(position 0)** and lock the lever **(A)** (for Radiomir models, screw it again).

SETTING THE DATE (FOR SOME MODELS ONLY)

1. Raise the lever **(A)** of the crown cap to release the winding crown **(B)**. For Radiomir models, unscrew the winding crown **(B)**.
2. Pull it out to the first click **(position 1)** and set the current date by turning the crown **(B)** clockwise **(a)**.
3. Return the winding crown **(B)** to the initial position **(position 0)** and lock the lever **(A)** (for Radiomir models, screw it again).

CALCULATION OF IMMERSION TIME (FOR SUBMERSIBLE MODELS)

During diving activities, the immersion time can be calculated thanks to the unidirectional rotating bezel **(G)**. At the start of the dive, turn the bezel **(G)** anticlockwise until the luminous reference dot is aligned with the minutes hand **(D)**. The immersion time can be read using the minutes hand **(D)** and the minutes shown on the bezel **(G)**. It is recommended to expose your Panerai watch to the light to ensure visibility of the dial, hands and the dot on the bezel.

Note: Confirm that your watch is running by verifying the movement of the seconds hand to guarantee proper operation during underwater activities.

ELEMENTARY RULE FOR DIVING

Please consider essential instructions, international standards and procedures as well as local recommendations and laws regarding any underwater activities to ensure your safety. All diving activities must be preceded by taking part in a course at an accredited diving school and obtaining a recognised diving certificate.

PANERAI

©2024 Officine Panerai AG

Officine Panerai Marketing & Comunicazione
Viale Monza, 259 - 20126 Milano - Italy
www.panerai.com

panerai.com